

# 7918

## Parts explanation

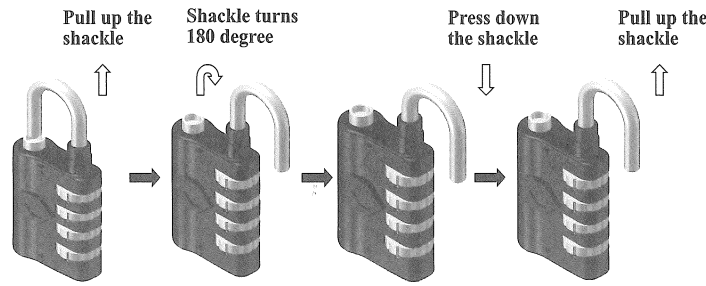
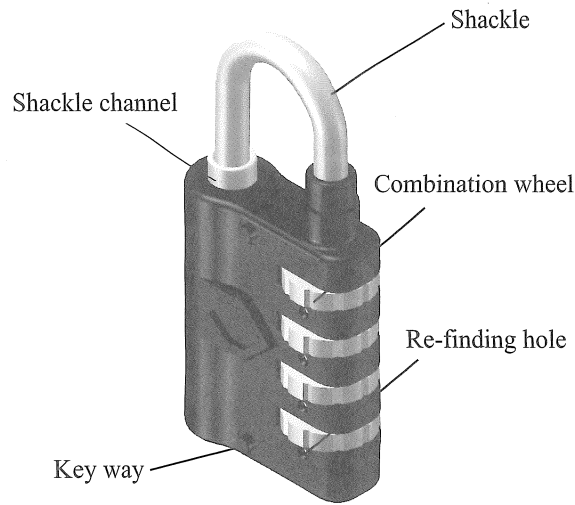

- 1-1. When setting combination wheels to correct combination code, you can pull up the shackle.
- 1-2. The shackle rotates to 180 degree.
- 1-3. To press down the shackle, then you can reset the combination code to you desired code.
- 1-4. To pull up the shackle, then the reset cation is done.

## IV、How to find out a setting combination code when you forget it?

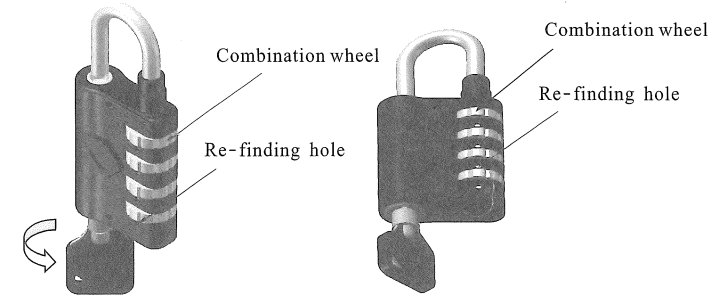

1. Make sure the Re-finding hole face is upward. To insert the key and rotate to the end (about 130 degrees).
2. Now you can turn the shackle freely. To press the shackle softly and let the lock body slant (this action will help the user to recognize the sign easily. See above figures). Please try to rotate the combination wheel one by one. If you see the White(Red) sign from Re-finding hole while rotating, that means your code is correct.

## Instruction:

### I、Manufacturer combination:

1. Manufacturer combination code set at 0-0-0-0. When setting combination wheels to 0-0-0-0, it's unlocked status, you can pull up the shackle and lock something.
2. Press down the shackle to the shackle channel (it's normal if you feel tigh or unsmooth when you press down the shackle) then adjust combination wheels randomly to lock.

### II、To reset combination code

1. The reset function can only be used when the lock is with correct codes and at unlock position.

### III、Open the lock by key

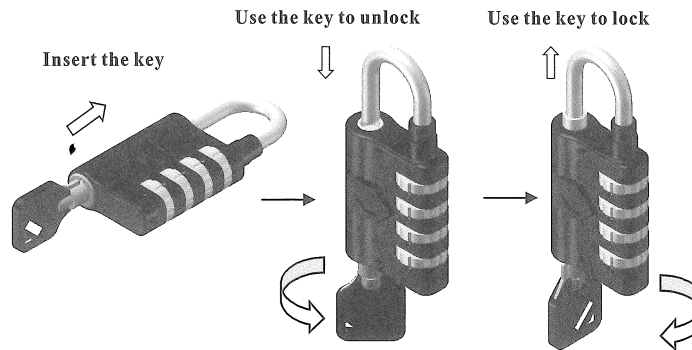

1. To insert the key and rotate to the end (about 130 degrees).
2. When rotate the key, the shackle channel will descend. The lock is open.
3. To rotate the key back to initial position (Make sure the shackle aim at shackle channel then rotate the key), and then will find the shackle channel is up. If the shackle lay inside shackle channel, and then it is locked.

### Press down the shackle



3. After all of the codes have been found, just turn the key back and pull it out, then the functions are normal again.

### Remark: 備註

1. After find out combination code if you press down the shackle mindless when you execute above step IV-2, it will be changed to reset code status above step II-1-3. The code will be changed if you turn around the combination wheel that time.
2. You can't rotate the combination wheel when the shackle was pull up.